

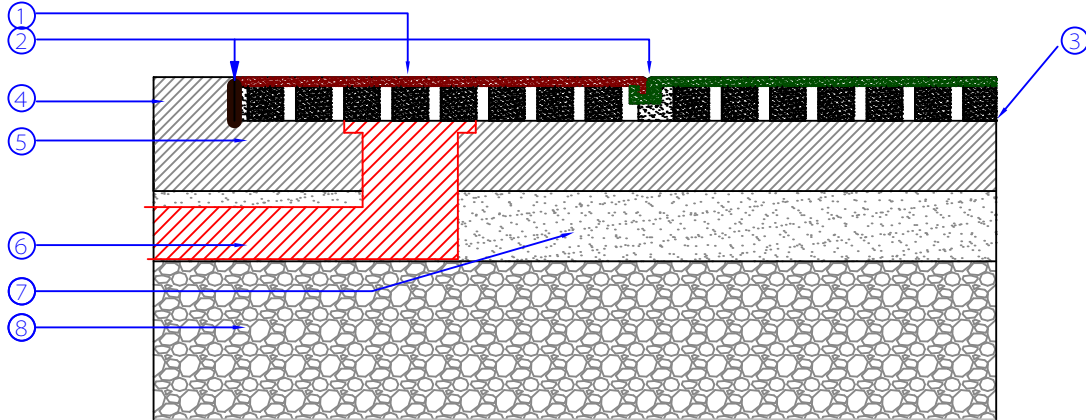

P.O. BOX 239, 4393 DISCOVERY LINE
 PETROLIA, ONTARIO
 N0N 1R0
 PHONE: (800) 263-2363
 PHONE: (519) 882-8799
 FAX: (519) 882-2697
 EMAIL: alltin@sosurfaces.com

CONTAINED SOFTILE OVER CONCRETE



LEGEND:

- ① SofTILE (See Specifications for Depth and Color).
- ② 1/2" Diameter Continuous Bead of SofTILE Adhesive at Each KrosLOCK Joint.
- ③ 1.0% Slope - 1/8" / 12" (3mm / 300mm).
- ④ Containing Sidewalk
- ⑤ Concrete Base
- ⑥ Drain
- ⑦ Compacted Aggregate
- ⑧ Compacted Subgrade.

THICKNESS	CRITICAL FALL HEIGHT (FT)		REVISIONS			
	WITH 10 YEAR PERFORMANCE WARRANTY PLUS SERIES	WITH 10 YEAR PERFORMANCE WARRANTY PREMIUM SERIES (EPDM)	REV	DESCRIPTION	DATE	APPR
2.00'	4.0	4.0	0	ORIGINAL ISSUE	3/26/09	
3.00'	5.0	5.0				
3.25'	6.0	6.0				
3.50'	7.0	7.0				
4.00'	8.0	8.0				
4.25'	10.0	10.0				
			SIZE	FSCM NO.	DWG NO.	REV
			A		2000 - 001	1
FILE NAME		PREPARED BY	SCALE	SHEET		
Contained SofTILE		B. GOSS		SK17		