

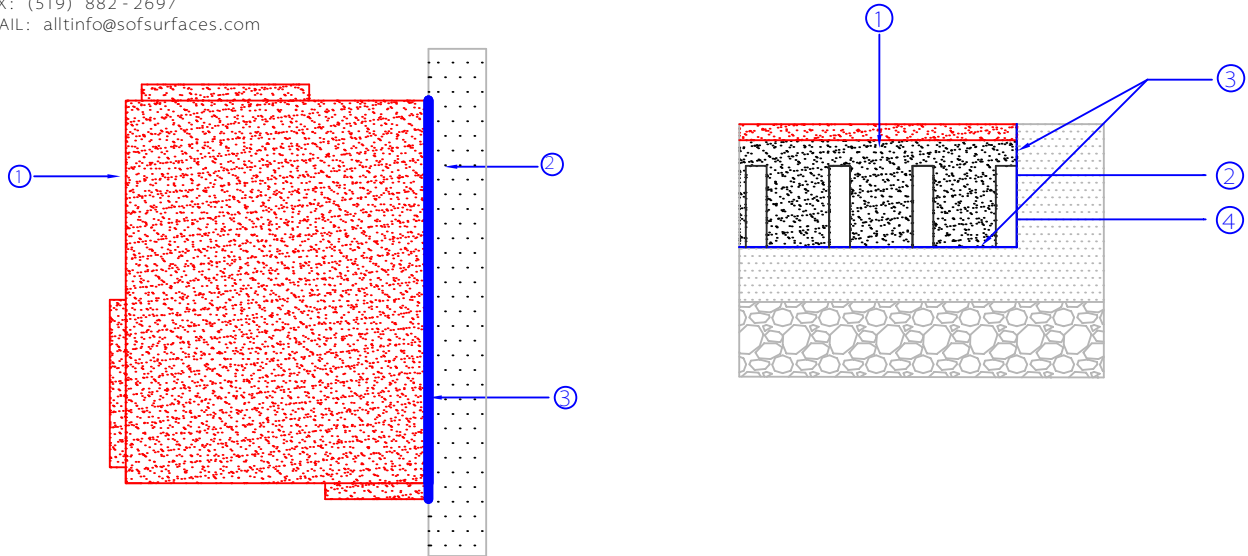

P.O. BOX 239, 4393 DISCOVERY LINE
 PETROLIA, ONTARIO
 N0N 1R0
 PHONE: (800) 263-2363
 PHONE: (519) 882-8799
 FAX: (519) 882-2697
 EMAIL: allinfo@sosurfaces.com

INSTALLATION OF KrosLOCK[®] TILE AGAINST A VERTICAL SURFACE (CONCRETE CURB, WALL OR TIMBER)



LEGEND:

- ① SofTILE[®] (See Specifications for Thickness and Color).
- ② Vertical Surface (Curb, Wall or Timber) See Specifications for Details.
- ③ Applied Adhesive (See Installation Instructions Below).
- ④ Window and Door Spray Foam May Be Applied If Extra Support is Required

THICKNESS	CRITICAL FALL HEIGHT (FT)		REVISIONS			
	WITH 10 YEAR PERFORMANCE WARRANTY	WITH 10 YEAR PERFORMANCE WARRANTY	REV	DESCRIPTION	DATE	APPR
	PLUS SERIES	PREMIUM SERIES (EPDM)				
2.00"	4.0	4.0	0	ORIGINAL ISSUE	12/17/03	
3.00"	5.0	5.0	1	ADJUSTED ADHESIVE APPLICATION	10/20/04	
3.25"	6.0	6.0	2	REVISED	02/02/06	
3.50"	7.0	7.0	3	REVISED	08/14/08	
4.00"	8.0	8.0	4	REVISED	06/02/09	
4.25"	10.0	10.0				
			SIZE	FSCM NO.	DWG NO.	REV
			A		1SK5	4
FILE NAME	A0001SK5	PREPARED BY	B.GOSS	SCALE	NTS	SHEET